



We are very family-oriented and extremely close to our families. When we joined WABC and our Sunday School class, we knew we were at "home" because everyone felt like family.

The joy of opening up God's Word with our brothers and sisters was a new emotion - one that filled us with excitement and strength. Our Sunday School discussions are stimulating and thought-provoking.

When tragedy struck our household several times by way of deaths and illnesses, it was apparent how much this new family meant to us. They rallied around us with support, love, prayer and yes, even food! We were lifted up by them when we didn't have the strength to lift ourselves up anymore.

Sunday School is one of the times of the week that we look forward to the most. It is a time not only to study about Jesus' life and God's Word - it is also a wonderful time of fellowship and reconnection with our spiritual family.

Michael and Tammy Wiggins

God never intended for His children to exist as an island. We the church are the body of Christ - fitted together - for the building up of itself (Eph. 4).



I believe Sunday School is the most effective way for the body of Christ to function as a family, encouraging each other to grow and mature in our faith. Today's society leads us to function on our own with little, if any, personal contact. God's Word tells us to bear one another's burdens. This requires personal involvement.

Sunday School offers the perfect environment for the building, equipping and edifying of the church the way God intends.

Janice Hodum



Many people say that a Sunday School class is like extended family. From my experience, Sunday School is my family.

In June of 2003, my mother passed away. Two years later, I lost my father as well. Without the support (love, prayers, encouragement, etc.) from the Sunday School classes at WABC, my family's losses would have been much harder to deal with.

With all the troubles and heartaches we must go through in this life, it is comforting to know that God has put in to place a group of people that are always there to help . . . no questions asked. This group of people is called a Sunday School class.

God has given us the gift of Sunday School. I encourage everyone to participate in what God has given.

Tony Smith



**REAL life people
REAL life issues
REAL LIVING SAVIOR**

REAL LIFE . . . That one phrase best describes what Sunday School is all about. Our Sunday School classes are made up of people just like you. These people encourage one another as they face everyday issues, support each other through the tough times, and stand together on the promises of God. You see, that's what Sunday School is all about . . . Helping each other grow. You have a place in Sunday School. Give it a try. It will change your life!



Washington Avenue Baptist Church
1621 N. Washington Ave. Cookeville, TN 38501
(931) 526-1917
Church website: www.wabconline.com

Mark Gaw, Pastor
Shane Bowling, Associate Pastor
Brian Tadlock, Music
Ryan McGann, Youth and Children's Minister



Washington avenue
BAPTIST CHURCH
Bringing People to Christ. — Mark 2:1-5

SUNDAY SCHOOL



HELPING EACH OTHER GROW

9:15am

Complete Class Listings and Locations Inside

PRESCHOOL

Age Group

0 - 12 months
 1 year olds
 2 year olds
 3 & 4 year olds
 Kindergarten

Location

302
 301
 303
 304
 408

CHILDREN

Age Group

1st Grade
 2nd Grade
 3rd Grade
 4th Grade
 5th and 6th Girls
 5th and 6th Boys

Location

413
 410
 407
 409
 212
 208

YOUTH

Age Group

7th - 8th Grades
 12th Grade Guys
 12th Grade Girls

Location

Youth Lounge
 Youth Lounge
 403

ADULT

Age Group

College
 New Members Class
 Young Adult 2 Co-Ed
 Young Adult 2 Men
 Median Adult 1 Women
 Median Adult 1 Co-Ed
 Median Adult 2 Co-Ed
 Adult 1 Women
 Adult 1 Men
 Adult 1 Co-Ed
 Adult 2 Co-Ed

Location

Fellowship Hall
 209
 406B
 404
 406A
 202
 105
 112
 CONF ROOM
 103
 101

1ST FLOOR - FAMILY LIFE CENTER

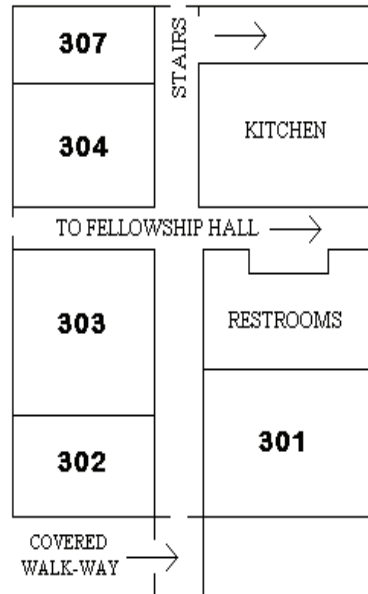

2ND FLOOR - FAMILY LIFE CENTER

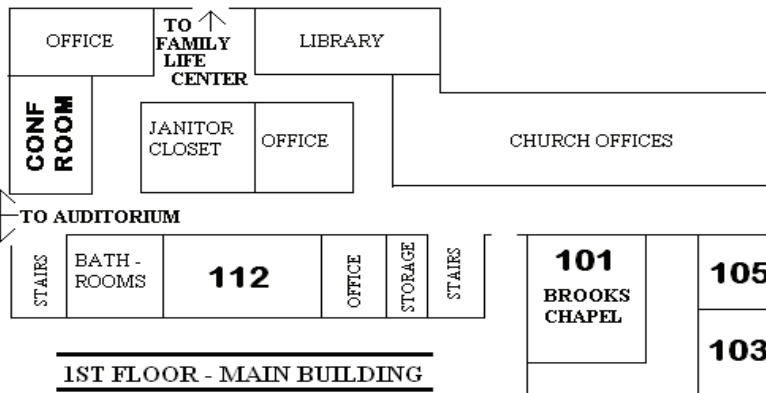
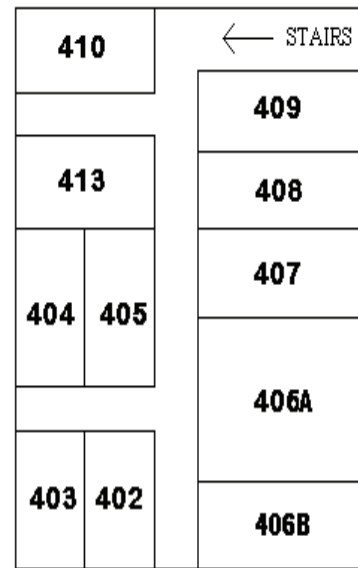

1ST FLOOR - MAIN BUILDING

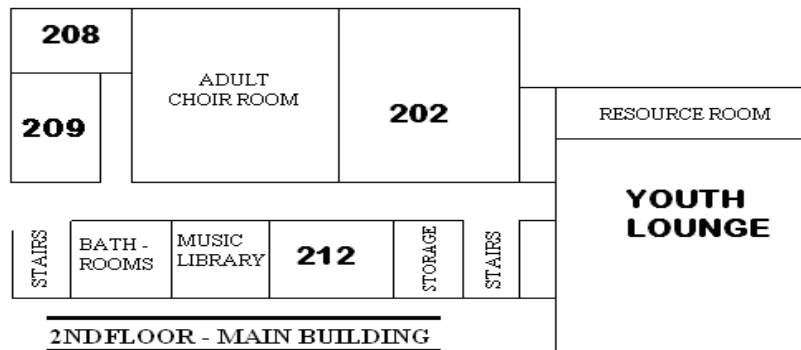

2NDFLOOR - MAIN BUILDING

ADULT CLASS DESCRIPTIONS

Young Adult 2 Co-Ed

In general, members in this class are age 25 - 35. If they have children, most of them are preschool age.
 Teachers: Johnny Wade & Mandy Gaspard

Young Adult 2 Men

Members of this class are men, most of them age 25 - 40. The class membership is diverse - Some are married, others are not; Some have children, others do not.
 Teacher: Bruce Dockery

Median Adult 1 Women (Sisters in Faith)

Members of this class are women, most of them age 25 - 40. The class membership is diverse - Some are married, others are not; Some have children, others do not.
 Teacher: Janice Hodum

Median Adult 1 Co-Ed

In general, members in this class are age 35 - 45. If they have children, most of them are elementary - middle school age.
 Teachers: Mike & Linda Stubblefield

Median Adult 2 Co-Ed

In general, members in this class are age 40 - 55. If they have children, most of them are high school age and older.
 Teachers: Dr. Oplless & Kay Walker

Adult 1 Women (Ladies Joy Class)

Members of this class are women, most of them age 55+.
 Teacher: Margaret Markum

Adult 1 Men

Members of this class are men, most of them age 55+.
 Teacher: Milford Cox

Adult 1 Co-Ed

In general, members in this class are 55+. If they have children, most of them are adults.
 Teacher: Gerald Pryor

Adult 2 Co-Ed (Chapel Class)

This class offers a larger community group setting. Most class members are age 45+.
 Teacher: Roy Gaw Jr.

New Members Class

This is a 4 week long class offered once a quarter for WABC new members.
 Teacher: Pastor Mark Gaw